



woodtec Fankhauser GmbH
Production Technology for Timber Construction

we make machines but
we love wood

Material Handling

 **swiss quality**

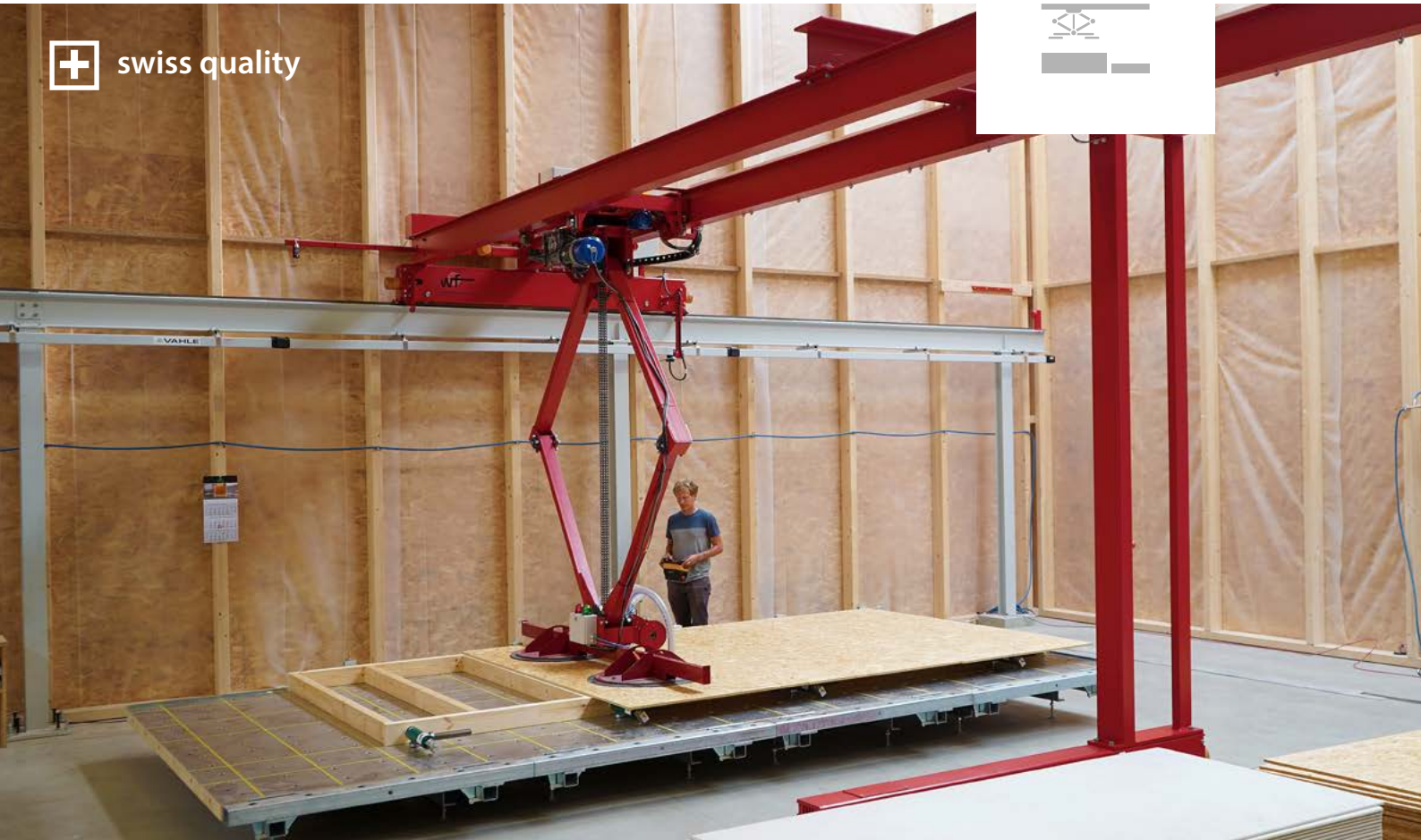

Material Handling

Vacuum Lifter and Handling Cranes for more Efficiency

Vacuum Lifter

Exceptional suction power for any porous wooden panels

For existing installations or in combination with woodtec Handling Cranes:



For Porous Materials

Pumpes and hoses are designed for high air flow and generate the necessary vacuum even with highly permeable materials such as OSB.



Protection Against Falling

Even in the event of a power failure, the full suction power is maintained for at least 5 minutes.

Max. Load
300 kg

Aktives Belüften

An additional motor ventilates the pads on vacuum off and prevents the lifter from inadvertently lifting off the already positioned panel

For Timber Frame Prefab

Particularly high throughput suction pads with ø70 cm and an adjustable spacing from 90 to 280 cm to cover all panel sizes.



Unburdening the Overhead Crane

No waiting or changeover times



Health Care

Prevents employees from lifting heavy materials by hand



Single Operator

Work process streamlined by over 50%

Four possible Crane Types:



Overhead Crane



Semi-Gantry Crane



Semi-Gantry Crane with Jib



Gantry Crane

Handling Crane Basic

The entry-level version for much more efficient handling of panels and heavy beams

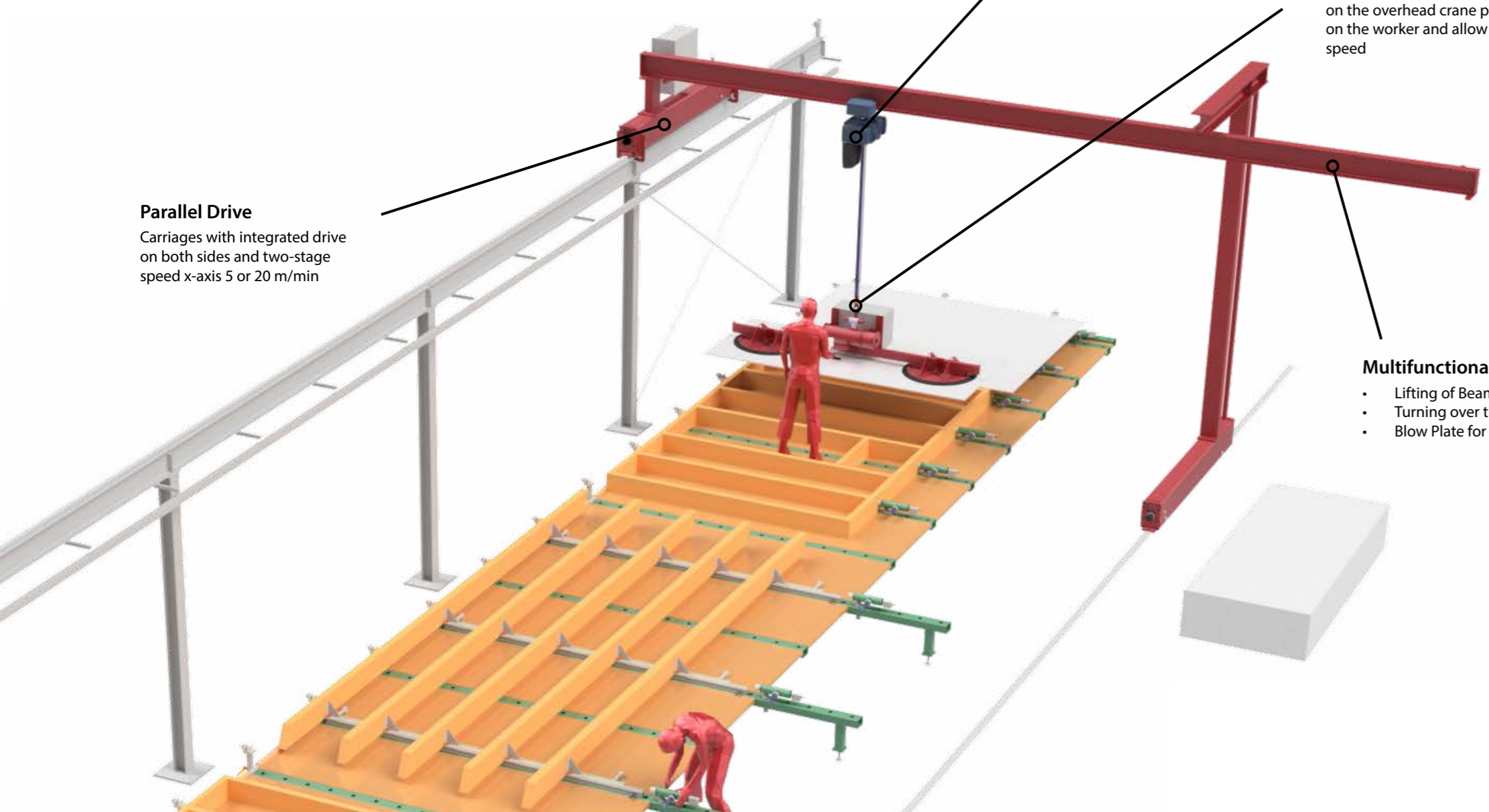

Parallel Drive

Carriages with integrated drive on both sides and two-stage speed x-axis 5 or 20 m/min

Two-stage Chain Hoist

With lifting speeds of 2.4 or 7.2 m/min and travel speed y-axis 5 or 20 m/min

Low Hook Height

Smaller swinging movements than on the overhead crane put less strain on the worker and allow a higher speed

Multifunctional

- Lifting of Beams
- Turning over the Frame
- Blow Plate for Insulation



Precise Positioning
Continuous operation via joystick



High Cycle Times
Scissors lift for fast Pick & Place



Intelligent Suction
Even porous panels are separated from the stack

Handling Crane Pro

The professional handling crane with scissor lift for even faster and more precise sheathing. With sensor-controlled additional functions.

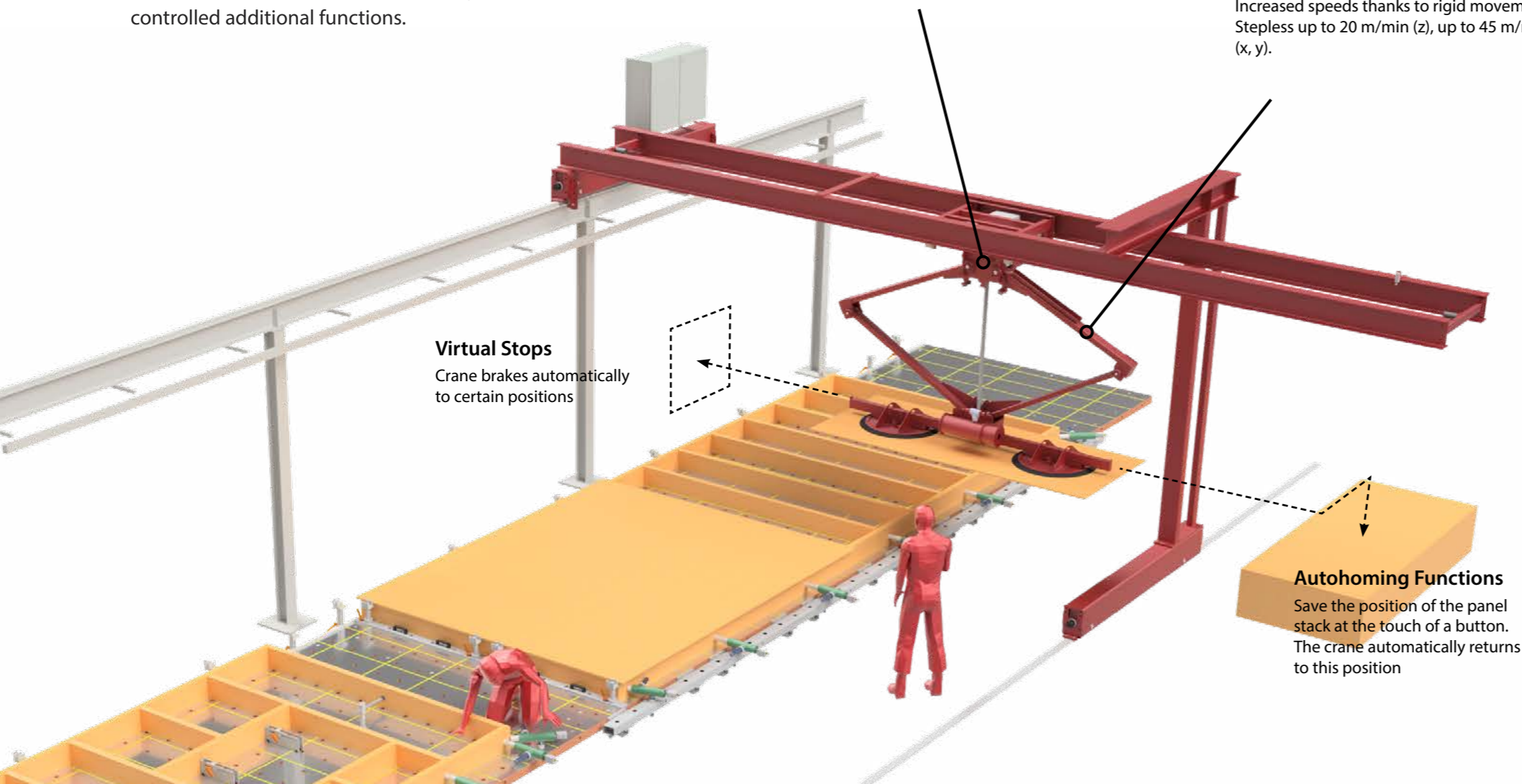

z-Axis Rotation
Stepless rotation up to 4 rpm or with predefined angular increments of 90°

High Dynamics thanks to telescopic z-Lift
Increased speeds thanks to rigid movement. Stepless up to 20 m/min (z), up to 45 m/min (x, y).

Virtual Stops
Crane brakes automatically to certain positions

Autohoming Functions
Save the position of the panel stack at the touch of a button. The crane automatically returns to this position



Large-format Sheathing
Reduce handling times and number of panel joints

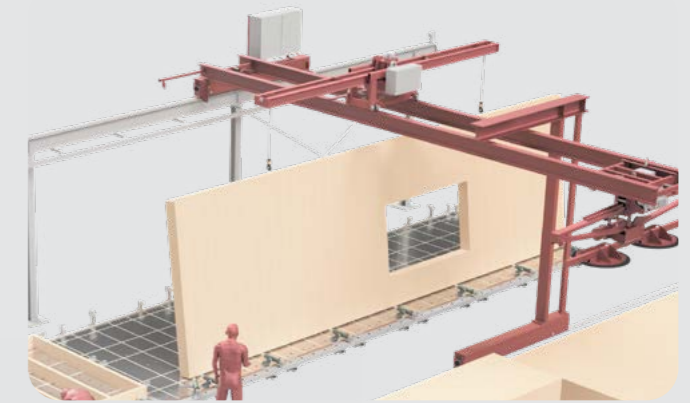

Turn-over and Transport
Additional module to further reduce the load on the overhead crane



Insulation
Fast displacement of the blow plate with auto functions



woodtec Fankhauser GmbH

Moosweg 1
CH - 4803 Vordemwald

tel +41 62 752 95 80
fax +41 62 752 95 84

info@woodtec.ch
www.woodtec.ch

More Information:
woodtec.ch/en/materialhandling



Timber Frame



**Cross Laminated Timber
CLT / XLam**



**Box Girders
Ribbed Slabs**



Material Handling